



ESP INSULATORS
Let's make the world cleaner and happier

Porcelain Insulators For Electrostatic precipitators



Hollow Ceramic Support Insulator

(72~120kV, $\leq 250^{\circ}\text{C}$ or $\leq 350^{\circ}\text{C}$, $\geq 500\text{kN}$)

Hollow ceramic support insulator is used as high-voltage insulating and sealing through which the discharge electrode suspension rod entering the electric field in an ESP, and in small size ESP it also functions as supporting of the discharge electrode system. By its configuration, it is classified into three types: cylindrical insulator, conical insulator and special-shaped insulator.

The hollow ceramic support insulator is glazed white or brown on surfaces inside and outside with both ends ground.

The ceramic support insulator conforms to the IEC, GB/T772-2005 and JB/T6746.(1-4)-1993 'ceramic insulator used in electrostatic precipitator'..

With different materials our ceramic support insulator can be used under the temperature $\leq 250^{\circ}\text{C}$ or $\leq 400^{\circ}\text{C}$ with the operating voltage ranging from 72~120kV and a mechanical compressive failing load not less than 500kN.

Cylindrical Support Insulator



Hollow Ceramic Support Insulator

Conical Support Insulator



Special-shaped Support Insulator

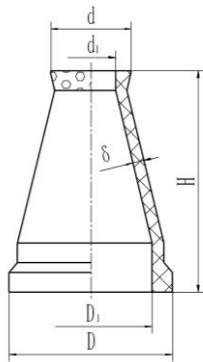

Drawing No.3-1

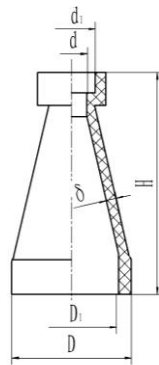

Drawing No.3-2

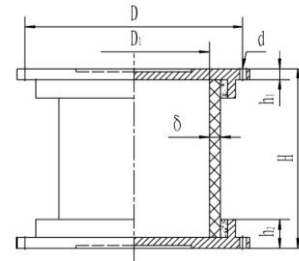

Drawing No.3-3

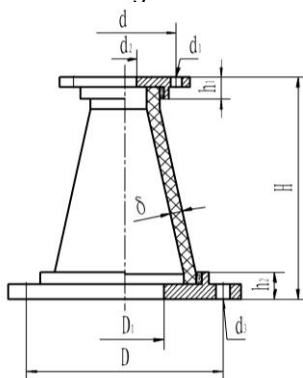

Drawing No.3-4

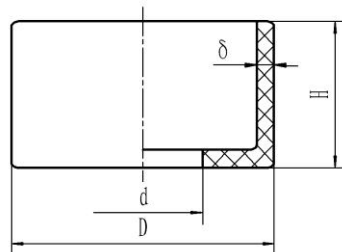

Drawing No.3-5

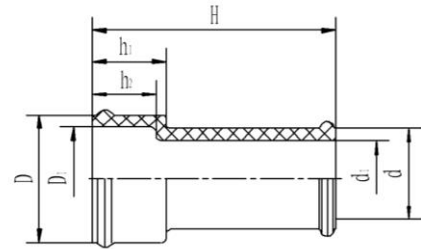

Drawing No.3-6

Special-shaped Support Insulator

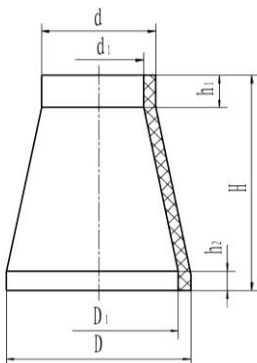

Drawing No.3-7

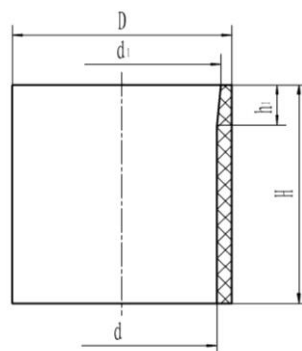

Drawing No.3-8

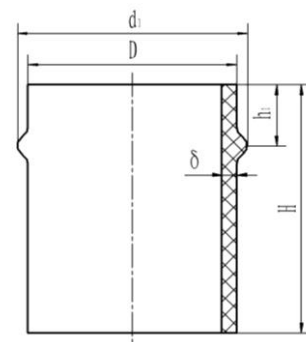

Drawing No.3-9

**Support insulator - conical, cylindrical**

P/N	Height	Bottom OD	Top OD	Wall thickness	Operating voltage (kV)	Product shape
3344	800	660	480	40	110	Conical
3340	800	640	460	30	110	Conical
3397	800	630	360	30	110	Conical
3242	800	400	400	30	110	Cylinder
3227	706	378	266	25	100	Conical
3209	700	680	380	30	100	Conical
3380	700	660	400	30	100	Conical
3202	700	660	300	30	100	Conical
3238	700	620	325	30	100	Conical
3234	700	580	310	30	100	Conical
3396	700	550	400	30	100	Conical
3386	700	550	360	30	100	Conical
3314	700	487	264	25	100	Conical
3324	700	450	450	30	100	Cylinder
3325	700	430	264	25	100	Conical
3223	616	487	435	30	90	Conical
3335	615	390	170	35	90	Conical
3218	610	510		30	90	Cylinder
3219	610	505		30	90	Cylinder
3224	610	482	432	32	90	Conical
3236	610	430	350	28	90	Conical
3216	610	425	345	28	90	Conical
3365	610	406	292	25	90	Conical
3369-2	610	350	350	30	90	Cylinder
3245	600	660	330	30	90	Conical
3228	600	660	300	30	90	Conical
3204	600	630	300	30	100	Conical
3208	600	600	380	30	90	Conical
3389	600	600	300	30	90	Conical
3393	600	580	300	30	90	Conical
3349	600	560	560	33	90	Cylinder
3350	600	560	480	33	90	Conical
3231	600	560	330	30	90	Conical



ESP INSULATORS

Let's make the world cleaner and happier

P/N	Height	Bottom OD	Top OD	Wall thickness	Operating voltage (kV)	Product shape
3356	600	560	230	30	90	Conical
3207	600	550	300	30	90	Conical
3395	600	530	300	30	90	Conical
3215	600	530	235	30	90	Conical
3243	600	520	520	30	90	Cylinder
3352	600	520	330	30	90	Conical
3363	600	520	225	25	90	Conical
3357	600	490	360	30	90	Conical
3366	600	480	300	30	90	Conical
3391	600	480	270	30	90	Conical
3355	600	440	300	30	90	Conical
3322	600	410		30	90	Cylinder
3371	600	400	400	25	90	Cylinder
3323	600	390	150	25	90	Conical
3235	600	370	270	25	90	Conical
3369	600	350	350	25	90	Cylinder
3233	584	510	355	30	80	Conical
3364	570	500	410	25	90	Conical
3377	570	500	260	30	90	Conical
3381	550	600	410	30	80	Conical
3205	550	520	520	30	80	Cylinder
3316	550	500	400	30	80	Conical
3387	550	500	300	30	80	Conical
3315	550	460	460	25	80	Cylinder
3368	539	362		25	80	Cylinder
3382	520	520	330	27,5	80	Conical
3222	520	450	350	25	80	Conical
3221	520	437	412	26	80	Conical
3318	520	350	350	25	80	Cylinder
3327	520	350	350	30	80	Cylinder
3332	520	350	300	25	80	Conical
3334	520	350	270	25	80	Conical
3225	515	425	425	32	80	Cylinder



P/N	Height	Bottom OD	Top OD	Wall thickness	Operating voltage (kV)	Product shape
3362	510	570	425	30	80	Conical
3232	510	490	325	25	80	Conical
3388	508	562	562	31	80	Cylinder
3217	508	425	425	30	80	Cylinder
3359	508	410	410	29	80	Cylinder
3384	502	575	575	30	80	Cylinder
3358	500	550	410	30	80	Conical
3373-1	500	487	328	25	80	Conical
3376	500	487	264	25	80	Conical
3206	500	480	300	30	80	Conical
3367	500	480	270	30	80	Conical
3210	500	455	315	30	80	Conical
3220	500	450	350	25	80	Conical
3378	500	450	350	27	80	Conical
3214	500	450	270	30	80	Conical
3373-2	500	437	328	25	80	Conical
3226	500	430	377	35	80	Conical
3331	500	430	235	30	80	Conical
3379	500	420	420	30	80	Cylinder
3347	500	420	225	25	80	Conical
3321	500	410	370	35	80	Conical
3333	500	400	300	30	80	Conical
3230	500	395	395	25	80	Cylinder
3361	500	376	264	25	80	Conical
3375	500	370	265	26	80	Conical
3392	500	350	295	25	80	Conical
3305	500	350	270	25	80	Conical
3320	500	350		25	80	Cylinder
3328	490	410	370	30	80	Conical
3398	480	550	400	25	80	Conical
3390	480	500	500	30	72	Cylinder
3336	480	500	400	25	80	Conical
3348	480	500	400	30	80	Conical



P/N	Height	Bottom OD	Top OD	Wall thickness	Operating voltage (kV)	Product shape
3399	480	460	400	30	80	Conical
3203	480	380	270	25	72	Conical
3372	470	430	240	25	80	Conical
3213	420	490	385	30	72	Conical
3351	400	550	400	25	72	Conical
3341	400	520	520	25	72	Cylinder
3330	400	500	500	30	72	Cylinder
3345	400	490	490	25	72	Cylinder
3306	400	460	460	30	72	Cylinder
3385	400	460	400	30	72	Conical
3303	400	460	330	30	72	Conical
3302	400	460	270	30	72	Conical
3212	400	435	250	30	72	Conical
3353	400	425	425	30	72	Cylinder
3307	400	400	400	30	72	Cylinder
3311	400	400	400	25	72	Cylinder
3304	400	400	300	30	72	Conical
3317	400	400	300	25	72	Conical
3343	400	400	300	25	72	Conical
3329	400	350	350	25	72	Cylinder
3301	400	350	300	25	72	Conical
3312	400	350	250	25	72	Conical
3319	400	320	320	25	72	Cylinder
3313	375	520	520	25	72	Cylinder
3339	375	500	500	25	72	Cylinder
3326	375	470	470	25	72	Cylinder
3310	375	435	435	30	72	Cylinder
3308	375	430	430	30	72	Cylinder
3338	375	425	425	25	72	Cylinder
3383	370	426	426	35	72	Cylinder
3240	370	422	227	26	72	Conical
3354	370	420	225	25	72	Conical
3374	260	230	190	20	—	Conical

**support insulator - special-shaped**

Work code	Main dimensions (mm)										Operating voltage (kV)	Drawing No.
	H	D	D ₁	d	d ₁	d ₂	d ₃	h ₁	h ₂	δ		
3201	1024	800	620	440	6-Φ15	260	12-Φ15	75	75	31	120	3-4
3211	726	490	430	100	200	—	—	—	—	30	100	3-2
3229	725	465	405	100	200	—	—	—	—	30	100	3-2
3237	620	390	—	—	430	—	—	130	—	25	90	3-9
3239	370	432	—	356	362min	—	—	25	—	—	72	3-8
3241	584	500	440	345	285	—	—	30	80	—	90	3-7
3244	500	430	380	265	215	—	—	75	40	—	80	3-7
3309	620	410	320	154	100	—	—	—	—	25	90	3-1
3337	760	370	310	102	180	—	—	—	—	25	110	3-2
3342	430	580	400	12-Φ17	—	—	—	55	25	30	72	3-3
3346	1030	800	620	440	6-M12	260	12-Φ15	75	75	30	120	3-4
3360	620	388	340	148	100	—	—	—	—	24	90	3-1
3370	150	520	—	300	—	—	—	—	—	25	—	3-5
3394	520	450	402	340	292	—	—	90	80	24	80	3-7
3501	800	390	330	290	230	—	—	260	200	—	120	3-6